

CPAM / DEREME
ECH 100°

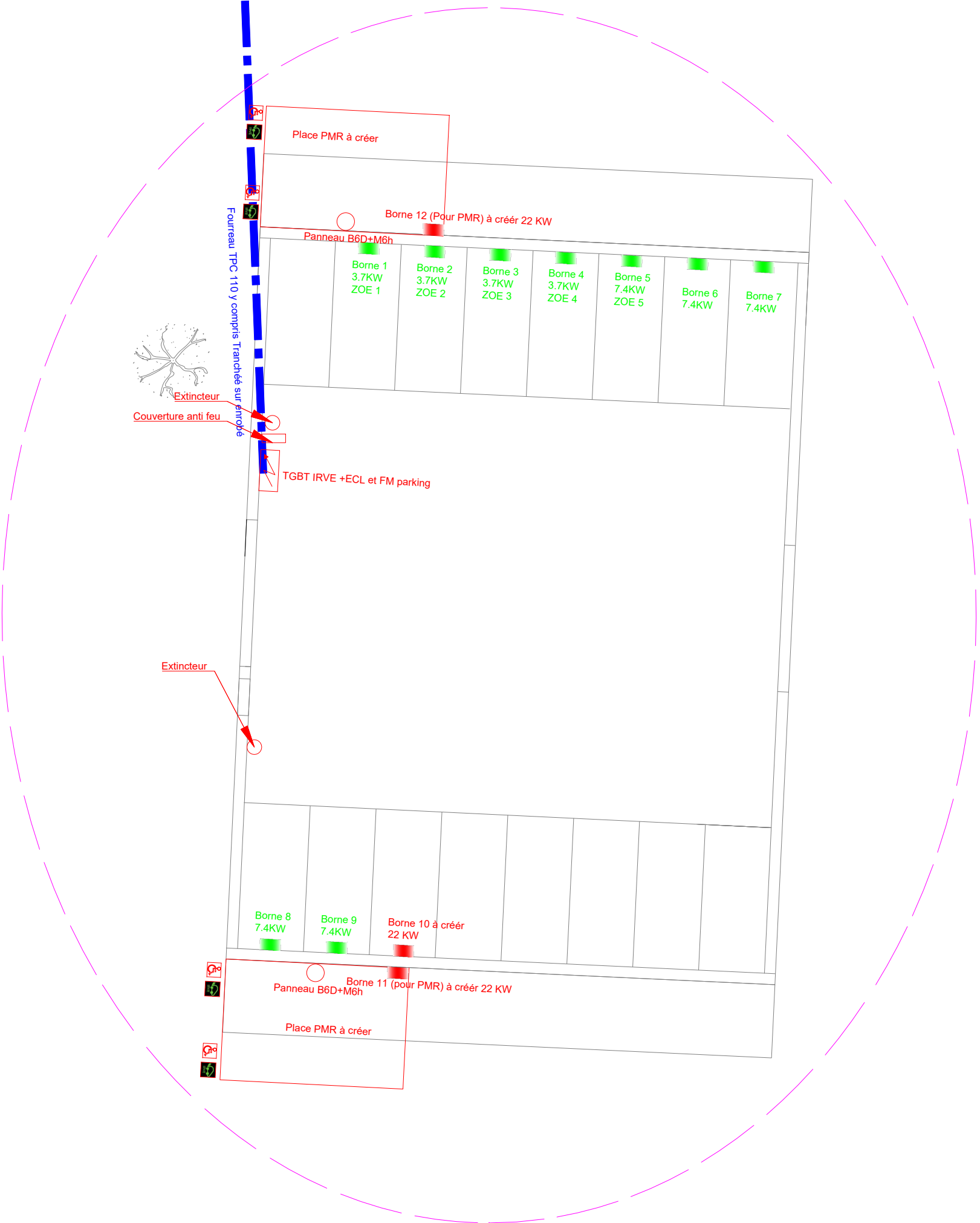

DETAIL 2

CPAM / DEREME
ECH 100°

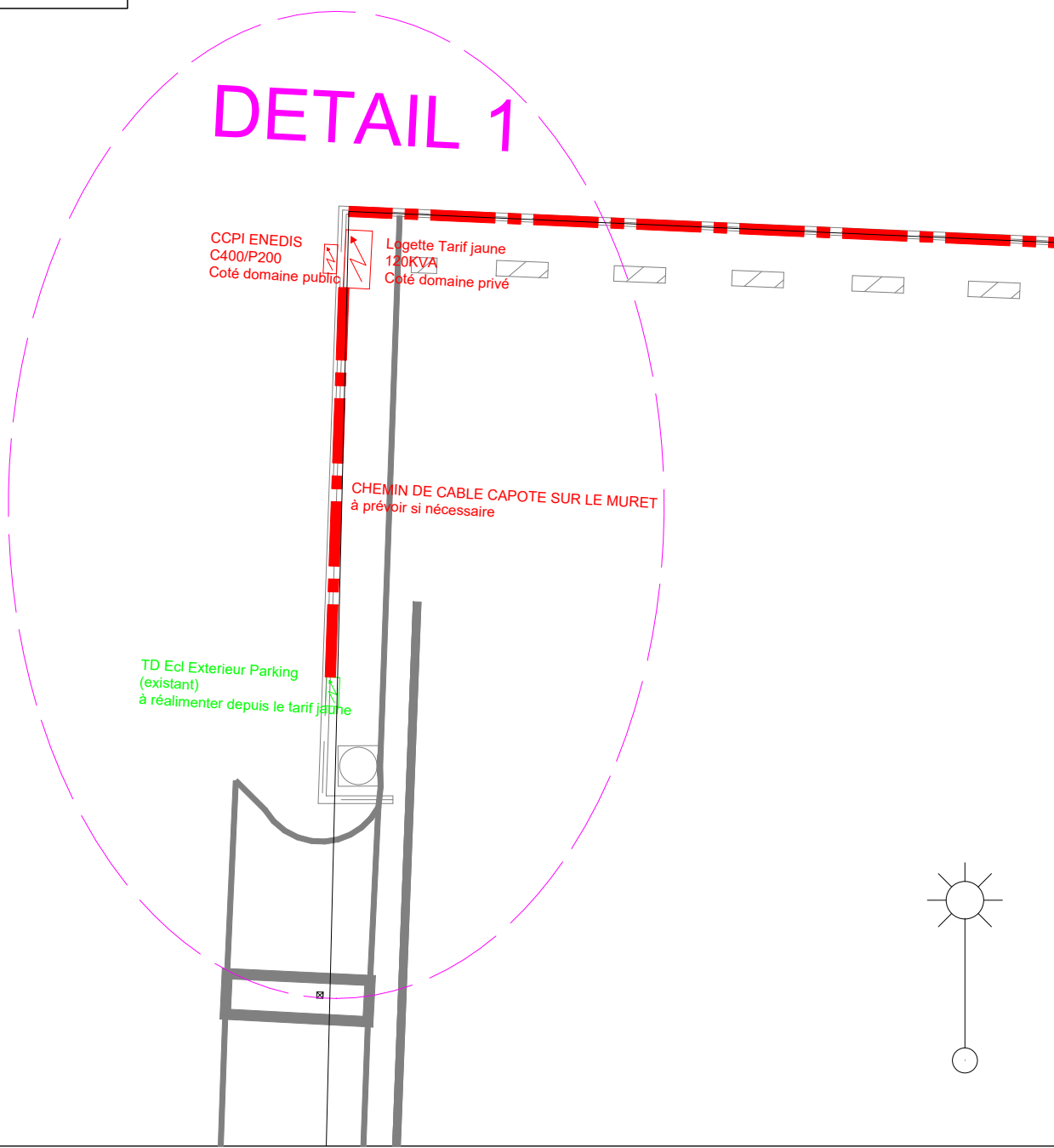

DETAIL 1

CPAM / DEREME
ECH 250°

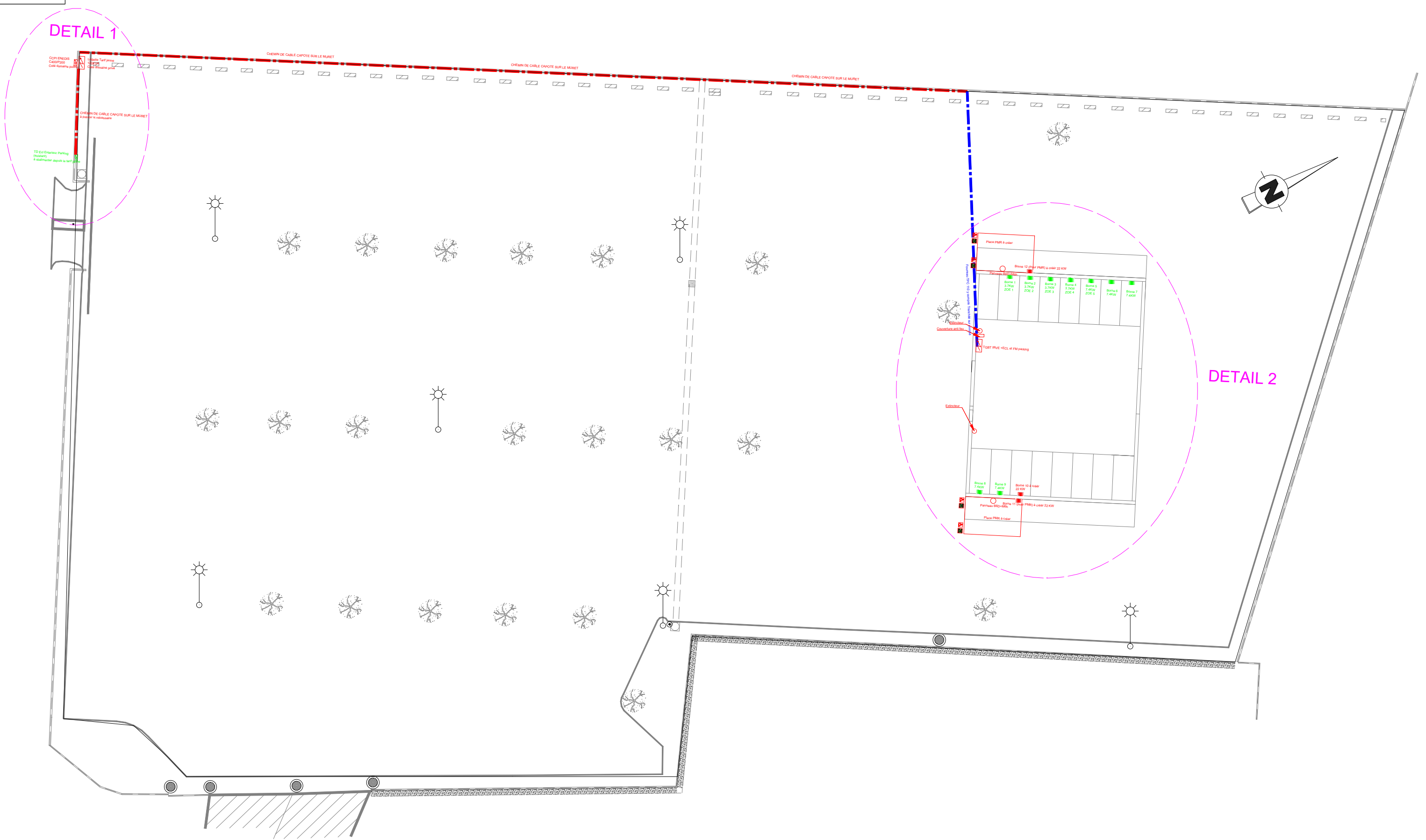

DETAIL 1

DETAIL 2



CPAM DE PAU

26 Bis avenue de lilas - 64 022 PAU

Extension IRVE SELON LOI LOM



Date	IND.	Objet modification
18/03/2025	0	1er édition

**REPERAGE TRAVAUX
IRVE
Phase 2**

EL03

DCE

24_0157 18/03/2025 / 0

LOT ELECTRICITE

Agence de Paris
Siège social - Casn
4, rue Irène Joliot curie
14 460 COLOMBELLES
02 31 71 18 02 | contact@reso-ing.fr

Agence de Paris
11, rue de Madrid
75 008 PARIS
02 31 71 18 02 | contact@reso-ing.fr

Agence de Bordeaux
1 Quai WILSON
33 130 Bègles
02 31 71 18 02 | contact@reso-ing.fr